

Waveguide Isolators

Part Number: KTWI740-19

Key Features

- Broad Frequency Range: 60.5GHz - 92.0GHz
- High Isolation, Low Insertion Loss, Small Size
- Wide Operating Temperature Range : -40°C~+85°C
- Commercial, Military and Space Applications

Electrical Specifications at Room (25°C±5°C) Temperature

Part Number	Freq. Range (GHz)	Bandwidth Max. (MHz)	Insertion Loss Max. (dB)	Isolation Min. (dB)	VSWR Max.	Waveguide Type
KTWI740-19	60.5 - 92.0	1000	0.8	18	1.30	WR12
KTWI740-19	60.5 - 92.0	2000	0.8	18	1.30	WR12

Mechanical Dimensions (mm)

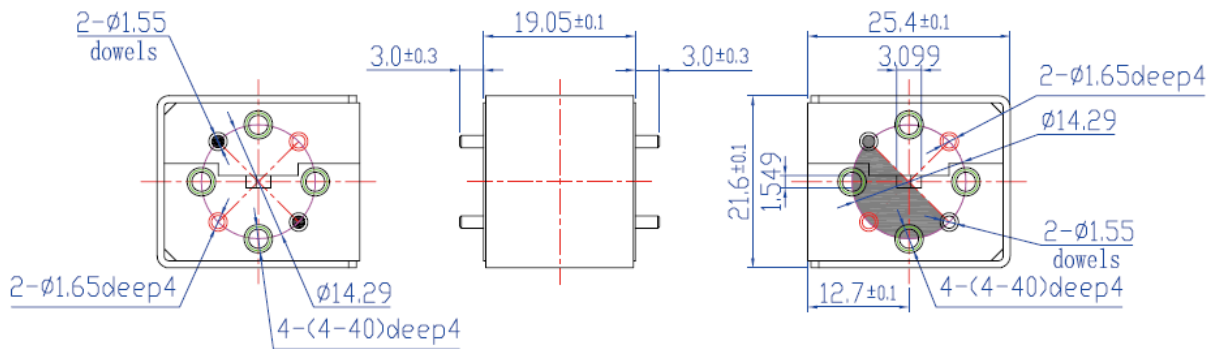

HOW TO ORDER

