

## Waveguide Isolators

Part Number: KTWI120-12.7A

### Key Features

- Broad Frequency Range: 9.48GHz - 15.0GHz
- High Isolation, Low Insertion Loss, Small Size
- Wide Operating Temperature Range: -40°C~+85°C
- Commercial, Military and Space Applications

### Electrical Specifications at Room (25°C±5°C) Temperature

Part Number	Freq. Range (GHz)	Bandwidth Max. (MHz)	Insertion Loss Max. (dB)	Isolation Min. (dB)	VSWR Max.	Waveguide Type
KTWI120-12.7A	9.48 - 15.0	300	0.3	20	1.20	WR75
KTWI120-12.7A	9.48 - 15.0	600	0.3	20	1.20	WR75

### Mechanical Dimensions (mm)

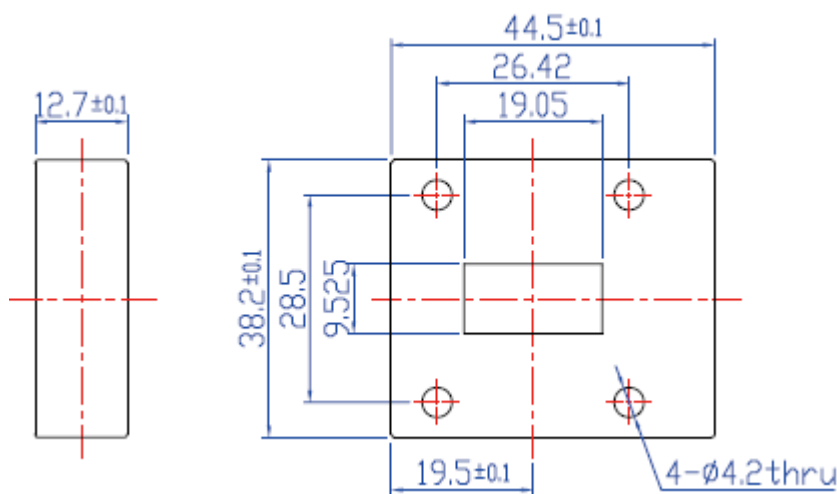

### HOW TO ORDER

