

## Drop-in Isolators

Part Number: KTDI0402-100

### Key Features

- Frequency Range: 0.35GHz - 0.55GHz
- Low Insertion Loss, High Isolation,
- Reliability Performance, High Power Handling
- Wide Operating Temperature Range : -15°C~+60°C
- Commercial, Military and Space Applications

### Electrical Specifications at Room (25°C±5°C) Temperature

Part Number	Freq. Range (GHz)	Bandwidth Max. (MHz)	Insertion Loss Max. (dB)	Isolation Min. (dB)	VSWR Max.	Reverse Power (W)	Connector Type
KTDI0402-100	0.35 - 0.55	40	0.4	20	1.25	100	TAB

### Mechanical Dimensions (mm)

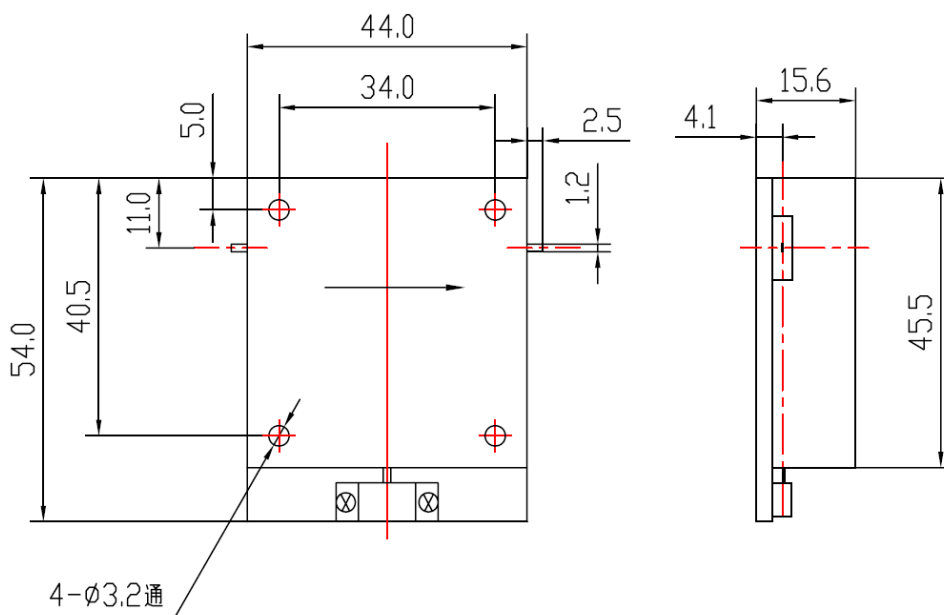

### HOW TO ORDER

