

Drop-in Isolators

Part Number: KTDI-402A

Key Features

- Frequency Range: 3.5GHz - 8.0GHz
- Low Insertion Loss, High Isolation
- Small Size, High Reliability Performance
- Wide Operating Temperature Range: -40°C~+70°C
- Commercial, Military and Space Applications

Electrical Specifications at Room (25°C±5°C) Temperature

Part Number	Freq. Range (GHz)	Bandwidth Max. (MHz)	Insertion Loss Max. (dB)	Isolation Min. (dB)	VSWR Max.	Reverse Power (W)	Connector Type
KTDI-402A	3.5 - 8.0	300	0.3	25	1.20	10	TAB
KTDI-402A	3.5 - 8.0	600	0.4	23	1.20	10	TAB

Mechanical Dimensions (mm)

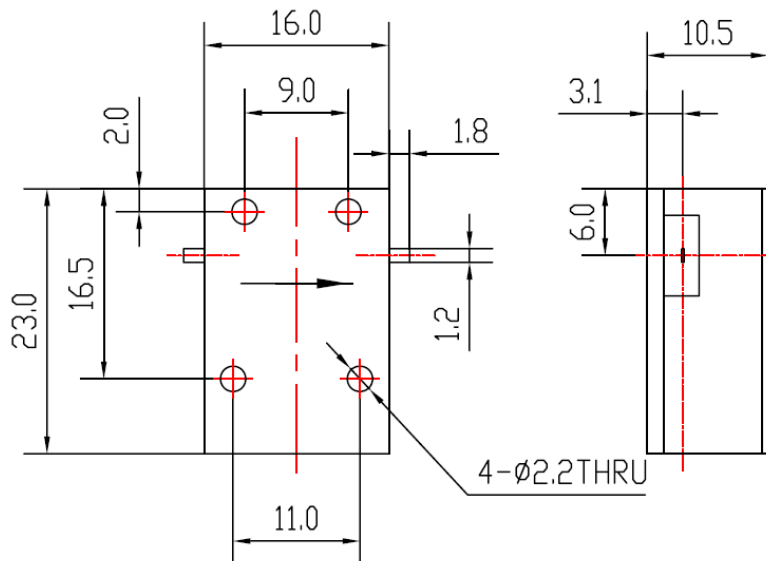

HOW TO ORDER

